

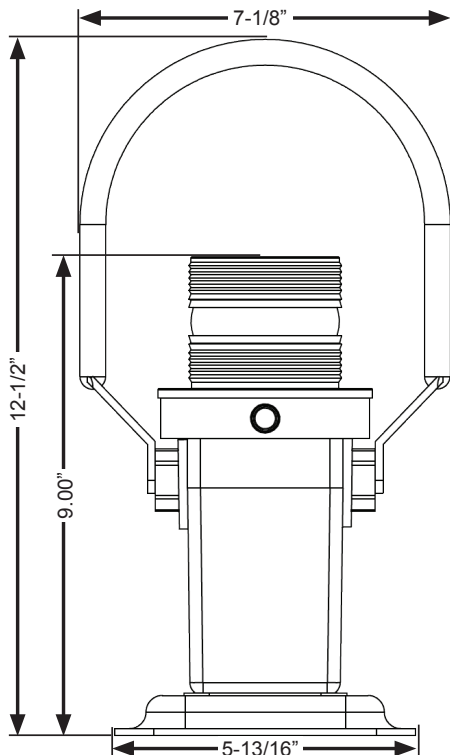

Square Base

**RR78-6L6V-.1-
BHSQ-RED-STDFL**



LED FLAG LANTERN

- High-impact UV Stabilized Polycarbonate construction and design
- Push Button Switch with Dual Mode functionality (Steady or Flashing)
- Gives high-intensity Red - Steady/Flashing
- Runs on 6-volt spring type battery (Not included)
- Square-extended or Conical Base
- 1-year repair/replace warranty
- High-efficiency LED available in Red, Amber, Blue & White
- Rated for 50,000 hours
- O-ring sealed LED head
- Convenient Bail-handle
- Weight: 2 lbs



Cone Base

**RR78-6L6V-.1-
BHCB-RED-STDFL**

**STEADY: 1.7CP; RANGE: 1.5 miles
FLASHING: 6.9CP; RANGE: 2-3/4 miles**

